

# KNITTING TECHNOLOGY

## DIAL LINKING MACHINE



THE FOREFRONT OF KNITTING TECHNOLOGY



日久電子工業有限公司

ETERNITY ELECTRONICS INDUSTRY CO., LTD.



# 日久縫盤機零件預覽表

## ETI THE TABLE OF DIAL LINKING MACHINE SPARE PARTS

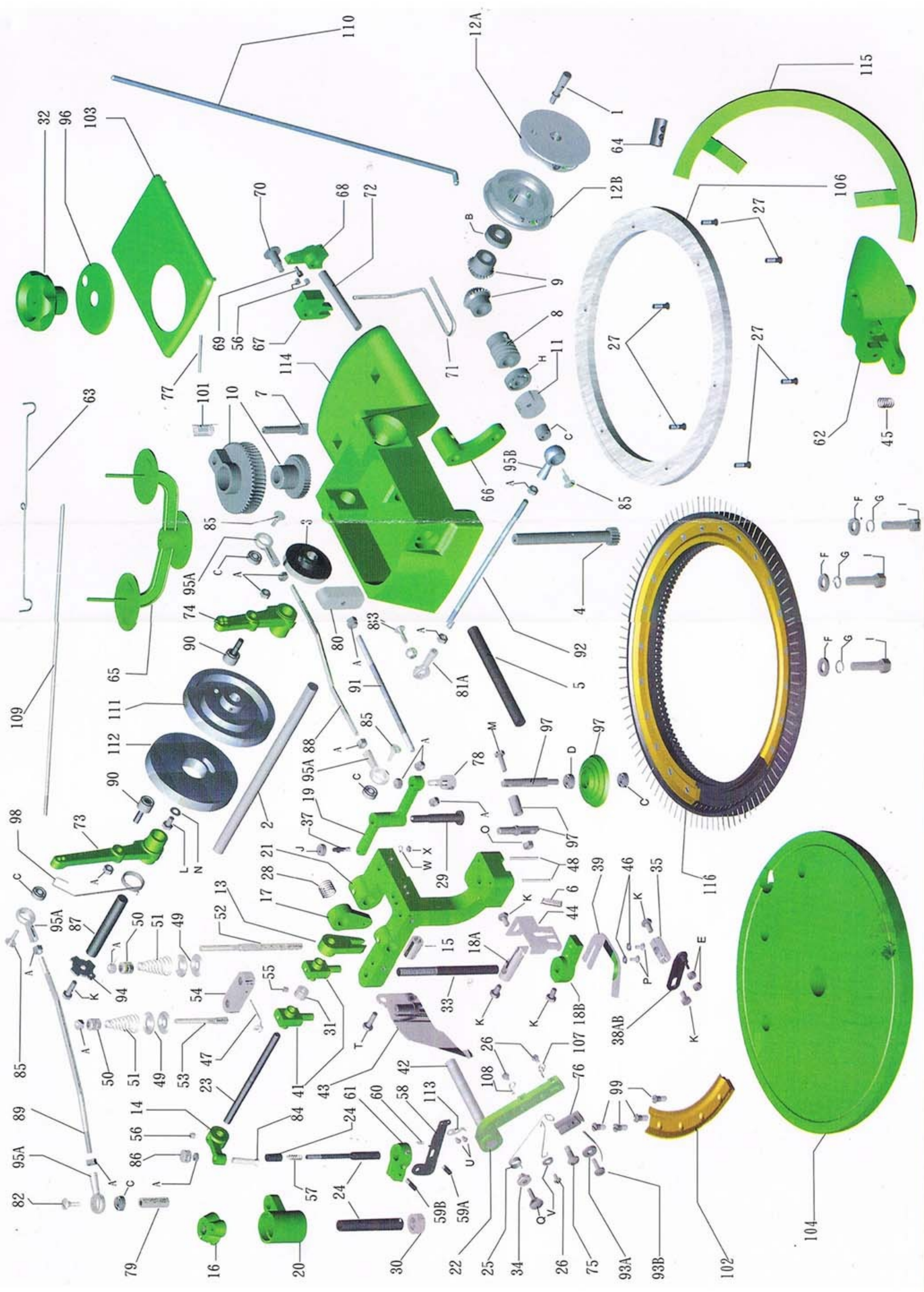







# THE FOREFRONT OF KNITTING TECHNOLOGY

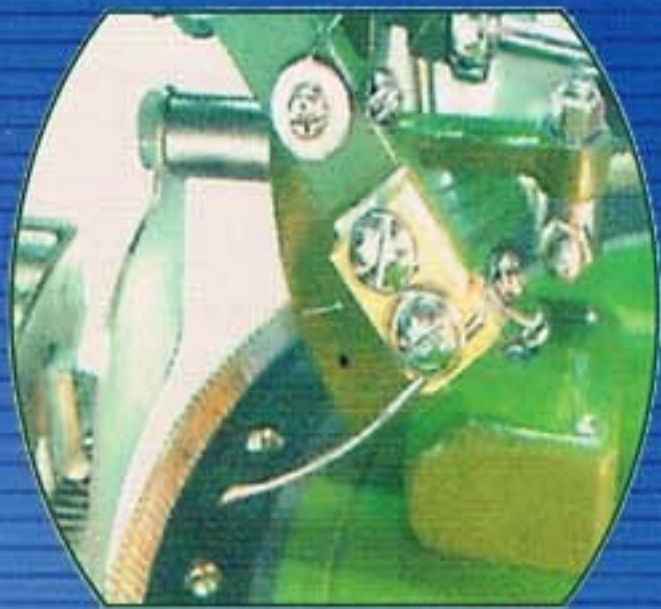

請看大針，在此位置才能撥動針盤，以免大針折彎、折斷。

Rotate the disc only when the hooking needle is on the position as illustrated, or the needle is

easy to bend and break.



跳綫 (1)：三角綫鈎是否和大針接觸，如無接觸，請調整此處 (如圖示)。

SKIPPING (1):

The hooking-needle must contact with the triangle-needle, if not, please adjust as illustrated.

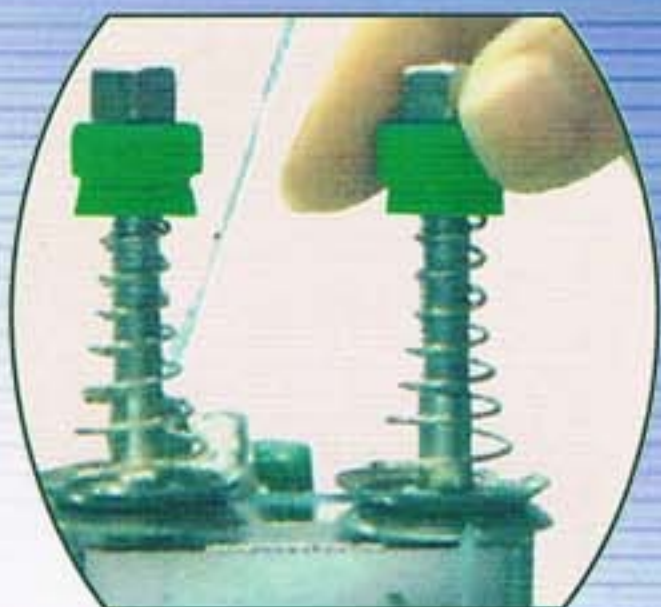

浮綫：請照圖示調整至適當為止。

Thread-Wafting

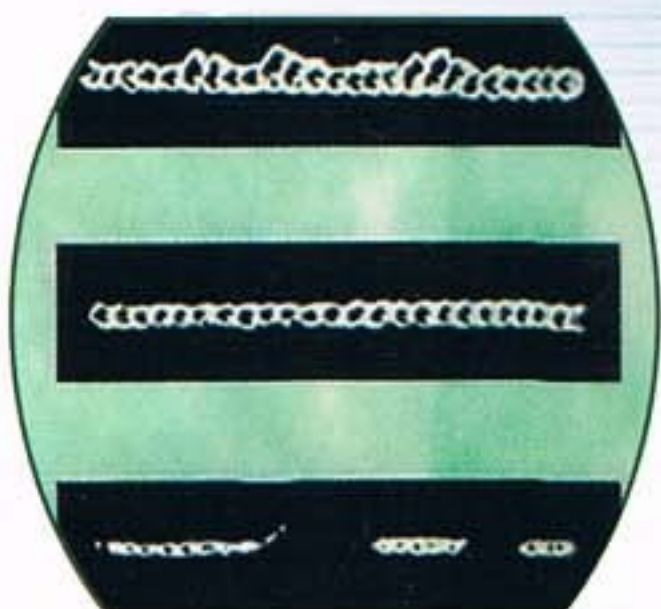

(1) 太松 Too Loose

(2) 適當 Suitable

(3) 太緊 Too Tight

1. 日久縫盤機，採用國外進口，高週波碳鋼承制。
2. 輕而簡便，精巧無聲，機件磨損少，滑潤系統絕對良好。
3. 外表附合時代設計，有精美耐度烤漆。
4. 實為毛衣界之優良生產工具。

5. 本機專為縫合各種外衣、毛綫衣之領口、袖口、肩膀以及各種縫合之用，性能優越、操作簡單，是生產界的福音。

## CHARACTERISTICS:

1. ETI DIAL LINKING MACHINE is manufactured by imported high frequency carbon steel.
2. Light & handy, **DELICATE & NOISELESS**.

with the least degradation in parts. Excellent in its lubrication system!

3. Modern designed appearance with beautifully durable enamelled colours.

4. An important tool to knitted garments business!

5. This machine is specially for connecting all knitted parts such as collar sleeves etc. Its superb quality, easy operation is a gospel to the manufactures!

Diameter of Dial	圓盤直徑	14"
Number of Gauges	針種	3~22 Gauges
Power Required	馬達	1/8 HP
Pulley Revolution	轉數	520 R.P.M
Weight	重量	32Kg
Packing Measurent	包裝規格	510mmX510mmX280mm

編織針別--縫合針別 WEAVE GAUGE--SEW GAUGE

1½G-----3G	10G-----12G
3G-----5G	12G-----14G
7G-----8G	14G-----16G
8G、9G-----10G	16G-----18.20G

大小針規格 GROZ-BECKERT NEEDLE SPECIFICATIONS

20G	= NO.2	10G	= NO.5
18G	= NO.3	8G	= NO.6
12.14.16G	= NO.4	6G	= NO.7
		3G	= NO.8



Eternity Electronics Industry Co., LTD

TEL:+886-6-279-7611

FAX:+886-6-279-7601

No.300, Lane 1, Zhongshan Rd., Rende Dist., Tainan City 717, Taiwan, R.O.C.

E-mail: sales@etigroup.com.tw / eti@etigroup.com.tw

www.etigroup.com.tw